

VARDHMAN WESTERN HEIGHTS

Premium Residential Apartments

residential apartments with
vibrant surroundings

Developers:



VARDHMAN BUILDERS & DEVELOPERS

Corporate & Site Office
S-21, Shyam Nagar Jaipur
Ph.: 0141-3141100

Promoters:

Kamal Sethia	93146 02100
Vivek Sethia	94140 57328
Amit Kotecha	94133 69678
Kuldeep Kotecha	94141 16655

Architect:

Space Grid
93149 18766
93145 10603

Disclaimer: This Brochure is purely conceptual and not a legal offering. Further the Promoters/Architect reserve the right to add/delete/ modify any details/specifications/elevation mentioned here in.

Def 'n' Dash™ @ 0141-2221991, 94142-41611

VARDHMAN WESTERN HEIGHTS

Premium Residential Apartments



an opportunity to enjoy global lifestyle

Presenting a wonderful opportunity to live in a dream home at a dream location. VARDHMAN'S WESTERN HEIGHTS is a prestigious realm of pleasure & comfort where you can enjoy easy accessibility to every desirable need. Located at the most affluent area of Jaipur, Shyam Nayar; it's an opportunity to enjoy global lifestyle. Also with modern civic amenities, convenient shopping centre & wide choice for recreational activities offered at a close proximity, life is a truly vibrant affair here. It's time to live in style and comfort. With a world class ambience of serenity and in vicinity of esteemed society, quality standards of living for your family is right here!



VARDHMAN
WESTERN HEIGHTS
Premium Residential Apartments

Specifications

Wood Work:

- Windows having Glass & Wire Mesh panels with safety grills.
- Wooden door window frames.
- Tough ISI mark 30 mm flush doors.
- Well designed main door of 35 mm thickness.
- Brass fitting of good quality on doors & windows.
- Wooden wardrobe with shutters in bedrooms.
- Premium class mortice locks & hardware accessories.

Apartment Features:

- Premium Class flooring of Vitrified Tiles/Marble.
- POP finish on wall & ceiling with cornices.
- Designer false ceiling in drawing/dining area.
- Acrylic Plastic paint on wall & ceiling.
- Natural spirit polish on doors & windows.

Toilet:

- Cubicle shower panel in master bedroom.
- Designer Spanish tile in toilet.
- Premium C.P. Fitting of



Crabtree/Marc Continental Range.

- Ceramic tiles in toilet upto 7' height on walls.
- C.P. accessories in toilet of Premium
- C.P. accessories in toilet of Premium Brand.
- Anti-skid ceramic tiles on floor.
- Counter wash basin in Master Bedroom toilet.

Kitchen:

- Black Granite working counters, stainless steel/ quartz sinks.
- 2' tiles dado above the counter.
- Modular Kitchen with chimney.
- Concealed Copper tubing for Gas line to nearest balcony.
- Separate Washing Area.

Electrical:

- Modern electrical system with concealed Copper Wiring.
- Premium quality Modular Switches & Accessories.
- TV/Telephone/A.C./Cooler point in all the rooms at appropriate places.
- Power backup (Silent D.G. Set) for common service.
- Fan, Exhaust & Tubelite provided.
- Decorative light in Drawing & Dining.

General Features:

- Planning as per vastu norms.
- Well designed entrance foyer & lobby.
- Earthquake resistant framed

structure design as per Seismic Zone II.

- Appropriate fire fighting arrangements.
- OTIS/KONE make low maintenance automatic lift.
- 24 hour water supply through own tubewell.
- Rain water harvesting system.

Security System

- Closed Circuit TV (in Entrance lobby/Parking area).
- EPBAX/ Intercom system.
- Well managed Security Service.

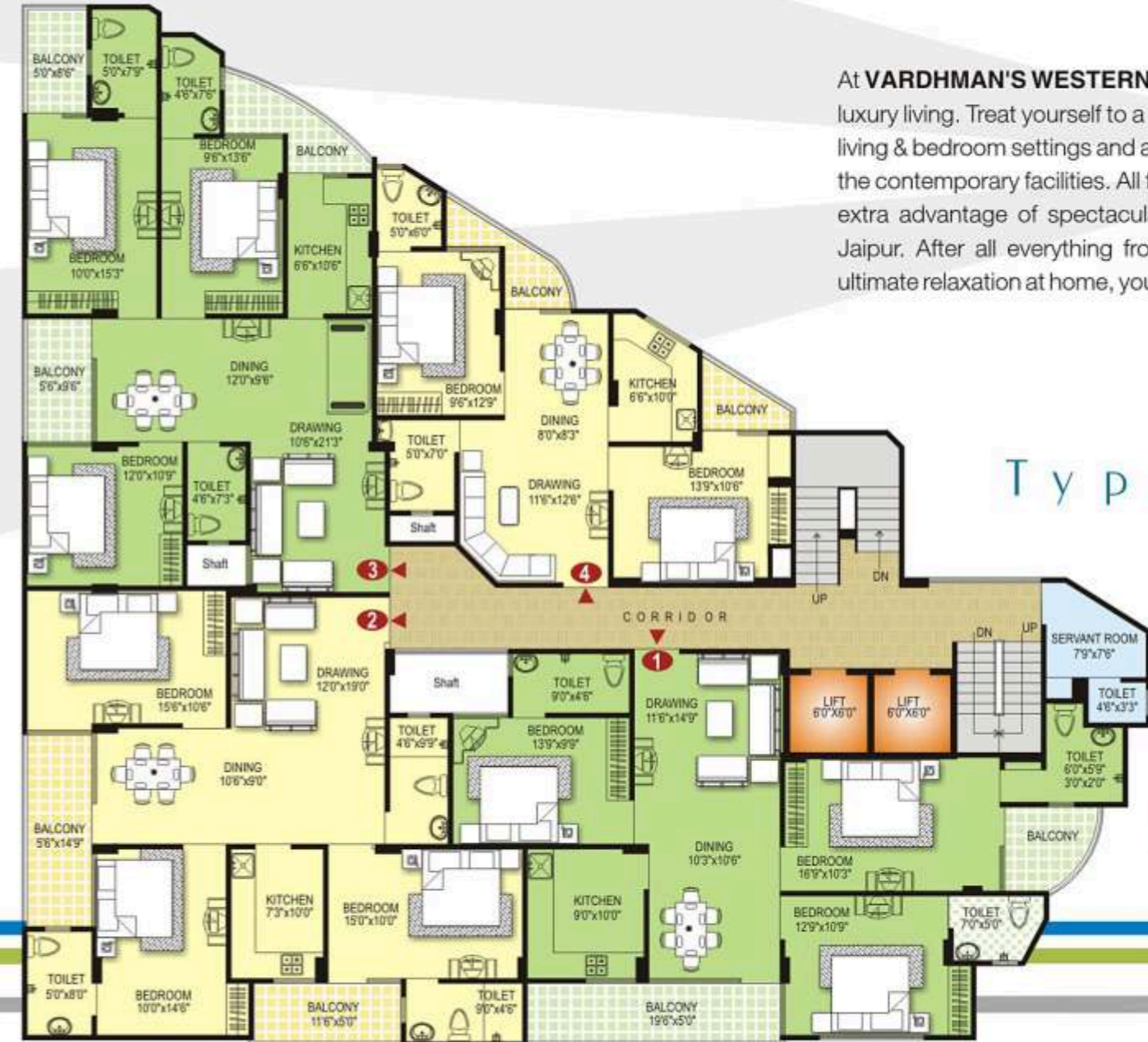

At **VARDHMAN'S WESTERN HEIGHTS**, you can relish the finer comforts of luxury living. Treat yourself to a luxurious lifestyle which includes ultra-modern living & bedroom settings and a fantastic gourmet kitchen with provision for all the contemporary facilities. All these superb conveniences are offered with an extra advantage of spectacular location, Shyam Nagar; which is pride of Jaipur. After all everything from enjoyment of living to shopping spree to ultimate relaxation at home, you can come across here.

Typical Floor Plan

1 S.A = 1594 sqft

2 S.A = 1645 sqft

3 S.A = 1549 sqft

4 S.A = 1003 sqft

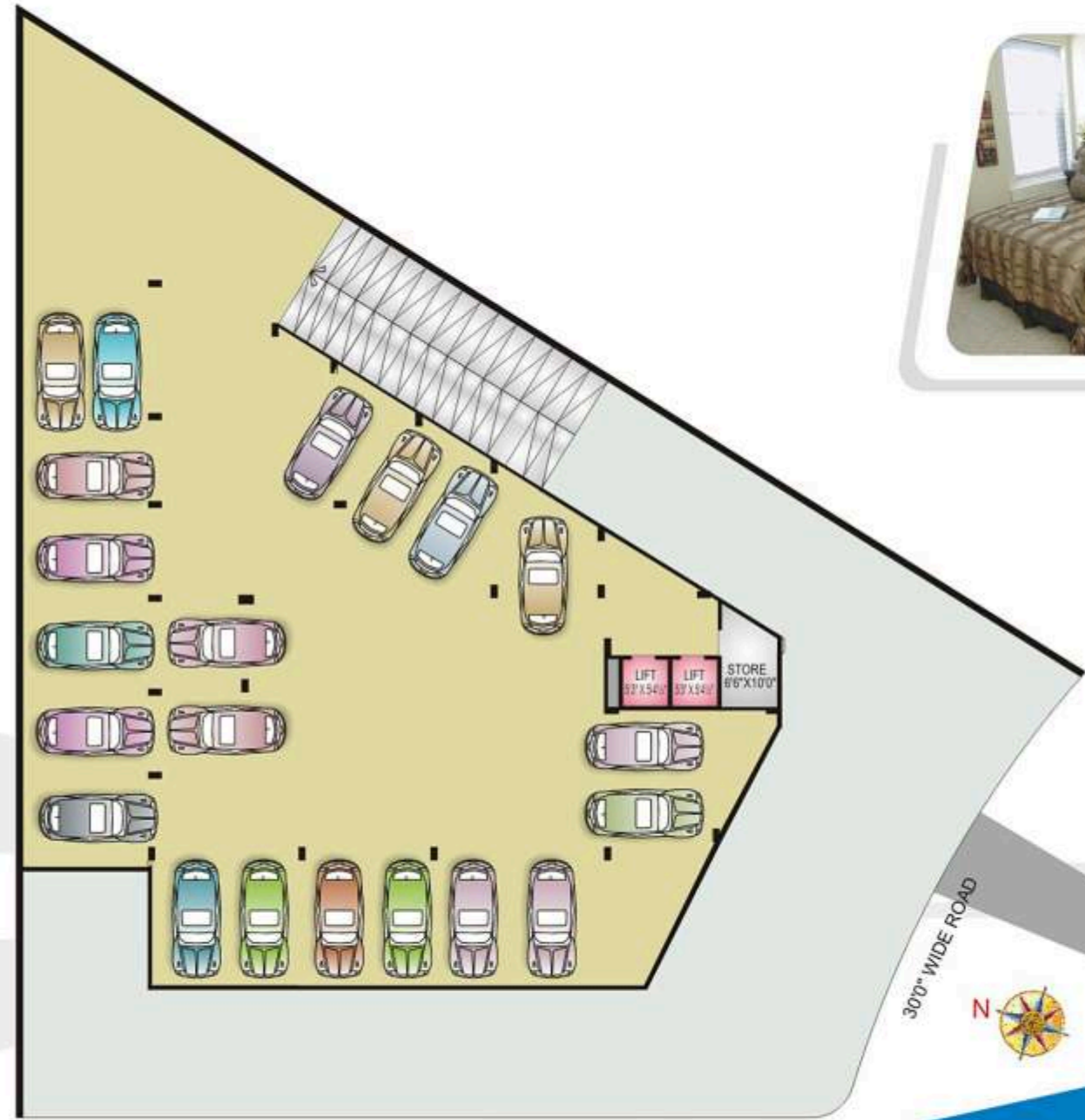

60'0" WIDE ROAD



BASEMENT
Floor Plan



60'0" WIDE ROAD



GROUND
Floor Plan